

3-Way ball valve S4 PVC-U
with electric actuator type E0412
Code 48

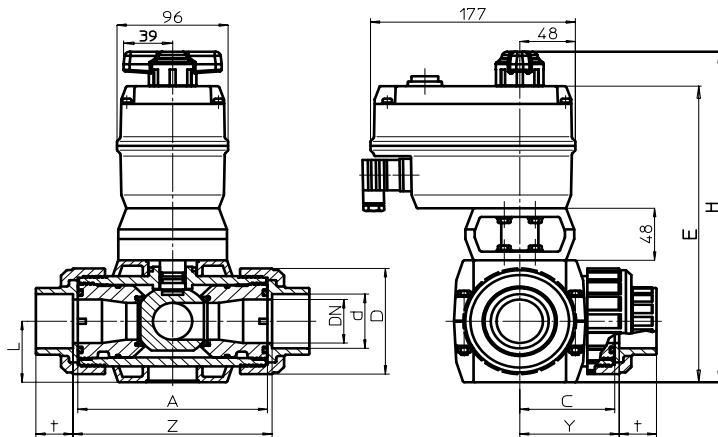

Technical data



Ball valve data

- O-rings, EPDM, FPM (Viton)
- ball seats, PTFE (Teflon®)
- valve body: PVC-U, PP, PVDF
- Range: DN32/d40 – 1 1/4" - DN50/d63 – 2"

- L or T ball

Operating pressure

DN32/d40 - DN50/d63: 10 bar (145PSI)

Valve end connectors

- Socket (DIN, ASTM, JIS)
- Spigot (DIN)
- Threaded (BSP, NPT)
- PE-fusion sockets (ASTM, DIN)
- PE-butt fusion spigots (DIN)
- Flange (DIN, ASTM, ASA, JIS)

Actuator features:

- fast travel
- ideal in aggressive environment
- manual override with visual position indication
- actuator can be field installed on to manual valves
- moulded mounting pad for second DIN plug
- 4 possible travel stops
- Actuator motor will be disconnected from voltage when selector switch is switched from AUTO to MANUAL

This data sheet represents data as of the date of printing. We reserve the right to change data without notice. All data are for informational purposes only

1bar = 14.5 PSI 1inch=25.4mm

Actuator		EO412		
d	mm	40	50	63
DN	mm	32	40	50
G	Zoll	1 ¼"	1 ½"	2"
A	mm	162,0	162,0	181,0
C	mm	81,0	81,0	90,5
D	mm	101,0	101,0	121,5
E	mm	277,0	277,0	293,0
H	mm	307,0	307,0	323,0
L	mm	56,0	56,0	64,0
t	mm	26,5	31,5	38,5
Y	mm	84,5	85,5	96,5
Z	mm	169,0	171,0	193,0
PN	bar	10	10	10

Parts diagram

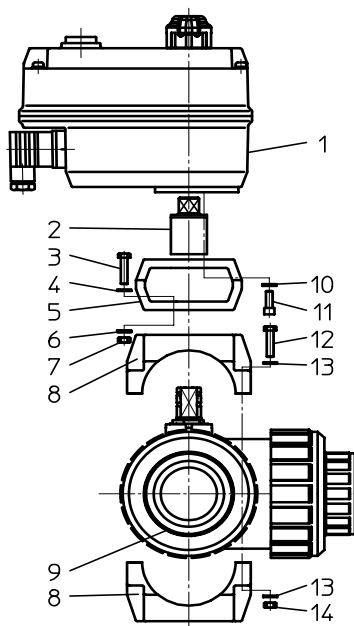

01. actuator
02. shaft coupler
03. hex head screw
04. washer
05. mounting channel
06. toothed lock washer
07. hex nut
08. valve brackets
09. ball valve
10. toothed lock washer
11. socket head cap screw
12. hex head screw
13. washer
14. hex nut

PRAHER – QUALITY – SERVICE – INNOVATION

3-Way ball valve S4 PVC-U
With electric actuator type EO412
 Code 48
 Ball valve series S4 PVC-U



Technical data

Logarithmic headloss diagram (metric)

1 USGPM = 3.78 liter, 10 l/min = 2.64USGPM
 1 bar = 14.5 PSI

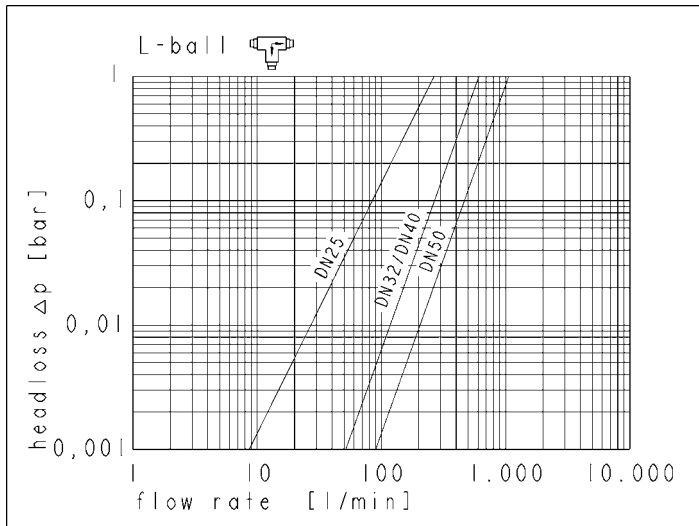

Pressure – Temperature diagram (metric)

1 bar = 14.5 PSI 20°C=68F 40°C=104F 60°C=140F

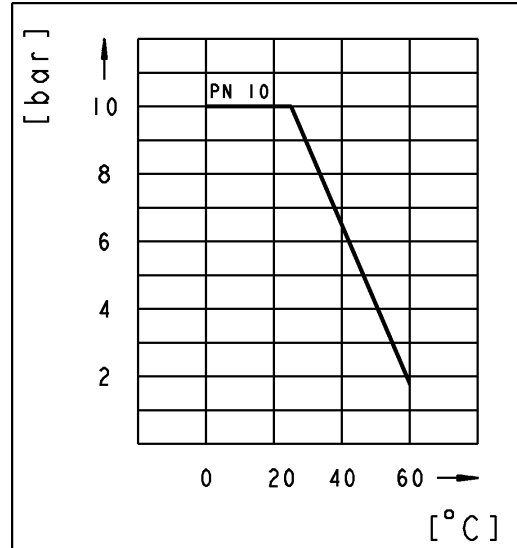

Technical data EO412

	EO412
Voltage	230 VAC ±10% 24 VAC ±10%
Frequency	50/60Hz
max. Inrush current	113mA – 50 Hz 122 mA – 60 Hz
Enclosure rating	IP65
Travel time	6 sec 90°
Travel range	Full 360 degree, set to 90° Two intermittent positions possible
Duty rating	60% max. 20 min
Electrical connection Device (plug)	3 phase DIN plug with ground DIN EN175301-803
Nominal torque	15Nm 130 inchlbs
Max. torque	20Nm 175 inchlbs
Temperature range	-15°C bis +60°C
Housing materials	ABS, fasteners - stainless A4
Position indicator	Visual with manual override handle
Manual override	integrated

Switching from MANUAL to AUTOMATIC

<u>Switching from MANUAL to AUTOMATIC</u>		
I. Automatic	II. Turn knob clockwise (knob must pop up)	III. manual
IV. Depress knob	V. Turn knob counter clockwise	VI. Automatic

3-Way ball valve S4 PVC-U
 With electric actuator EO412
 Code 48



Technical data

Wiring diagram

